

Specification sheet LX 727

Parapet Drainage Series 43 Parapet-Direct main emergency combination

main emergency combination

Gravity flow	Gravity flow
Silent	Silent
Discharge rate: 4.0 l/s	Discharge rate: 4.0 l/s
Water height: 35 mm	Water height: 75 mm
Roof penetration: 103 mm	Roof penetration: 103 mm
Diameter: DN 100	Diameter: DN 100
LX-Number: LX 727	LX-Number: LX 727
Weir height: 0 mm	Weir height: variable
Drain: ventilated	Drain: ventilated
Downpipe: ventilated	Downpipe: -
Downpipe height: min 4.2 m	Downpipe height: 0 m
Drainage: in sewer	Drainage: into the open
Flange form: bonding flange	Flange form: bonding flange

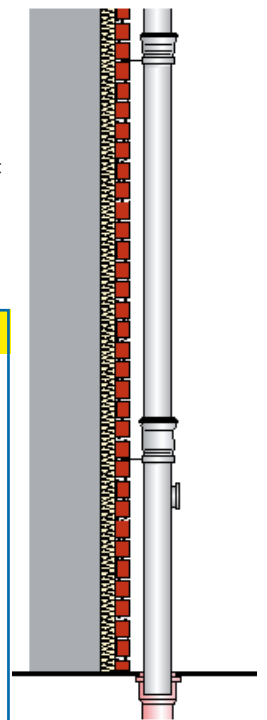
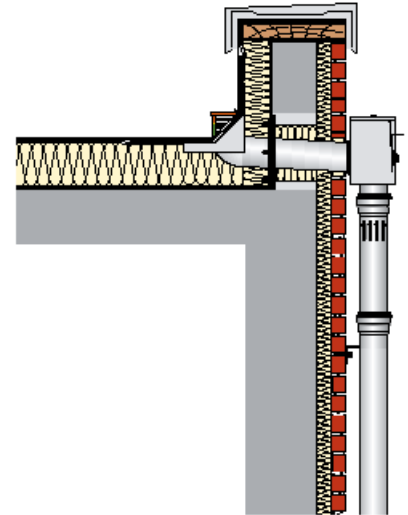

LX 727 Piece list

- 1 x Art.-Nr. 01324.100X, Double pipe parapet direct drain
- 1 x Art.-No. 01321.000X, LORO-X insulation block
- 2 x Art.-No. 01301.100X, LORO-X Pipe with one socket
- 1 x Art.-No. 13228.100X, LORO Sliding flange
- 1 x Art.-No. 00445.100X, LORO-X Collector box for double pipe
- 1 x Art.-No. 13218.100X, LORO-X Ventilation piece

- 1 x Art.-Nr. 01001.100X, LORO-X Pipe with one socket
- 1 x Art.-Nr. 05510.100X, LORO-X Standpipe
- 6 x Art.-Nr. 00911.100X, LORO-X Sealing elements
- 3 x Art.-Nr. 00975.100X, LORO-X Pipe clips
- 1 x Art.-Nr. 00986.000X, LORO-X Lubricant
- 3 x Art.-Nr. 09604.200X, LORO-X Hanger bolt

hQ - Discharge curve

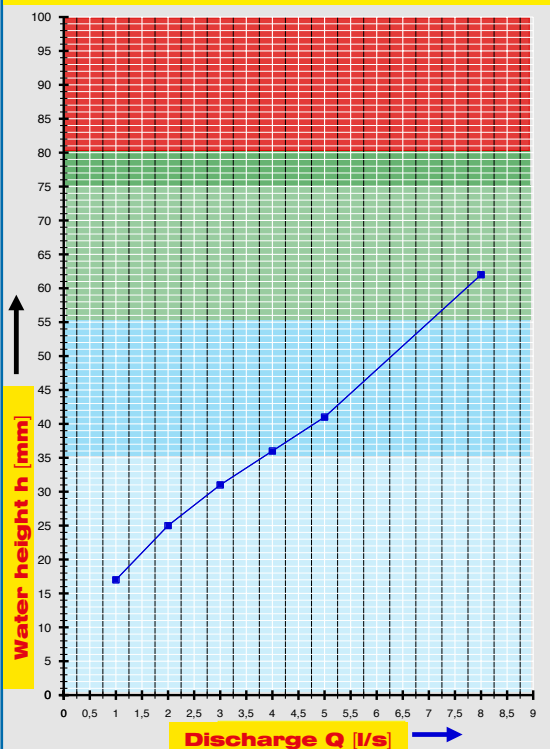

System power

CAD

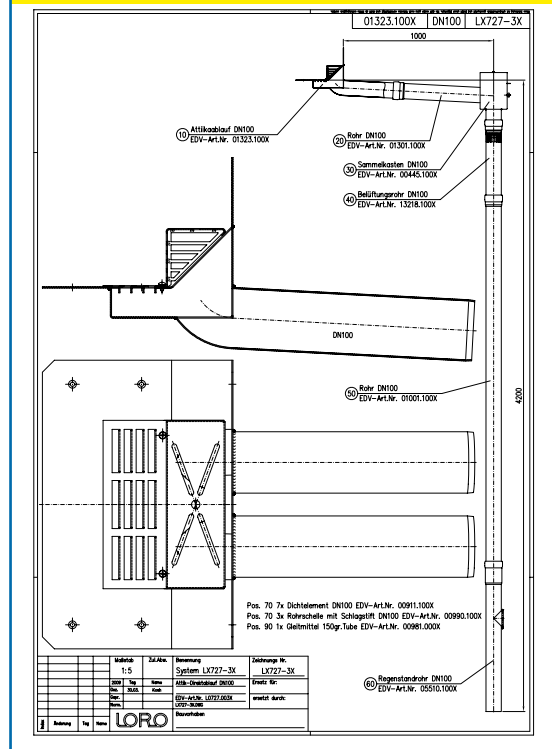

System shape

Water height	mm	5	10	15	20	25	30	35	40	45	50	55	60	65	70	75	
Discharge	l/s			0.9	1.7	2.0	2.9	4.0	4.7	5.5	6.7	7.0	7.7	8.0	8.0	8.0	
		Silent							Silent Power								

LORO-X double pipe parapet direct drain, with basin

Individual component
LORO-X double pipe
parapet direct drain
 with bonding flange for
bituminous roofing sheets

Drain: Art.-No. 01324.100X
 Weight: 10.7 kg

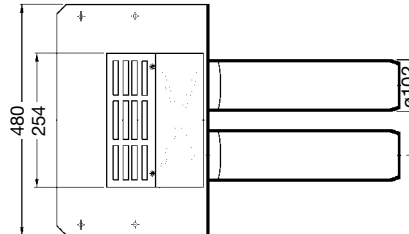
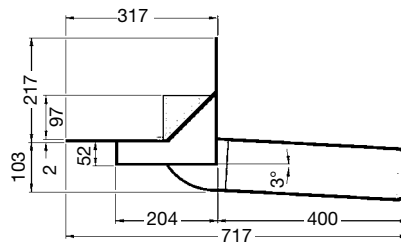

Individual component
LORO-X drain collector box

for LORO-X main emergency combination
 double pipe parapet direct drain with height-adjustable weir,
 made of galvanized steel, DN 100
 Art.-No. 00445.100X
 Weight: 5.0 kg



Individual component
LORO-X ventilation pipe

for LORO-X main emergency combination
 double pipe parapet direct drain,
 made of galvanized steel, DN 100
 Art.-No. 13218.100X
 Weight: 3.7 kg



Individual component
Sliding flange for
LORO-X parapet direct drains

for attaching the vapor barrier,
 as fixed and loose flange construction,
 made of galvanized steel,
 including sealing elements
 Art.-No. 13228.100X
 Weight: 4.9 kg

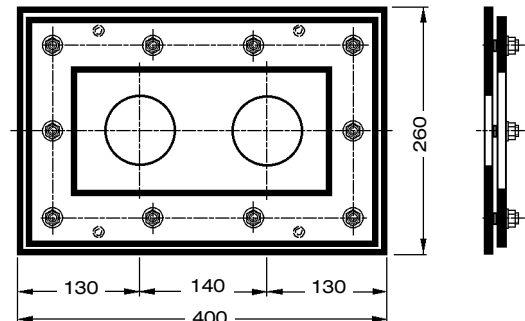
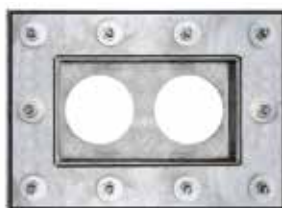

Trace heating: Lorowerk recommends to check all drains and pipes with regard to their frost-sensibility. Where necessary, these parts should be equipped with a trace heating.